

Isometric view (1:2)

- 주 기)
1. 최고사용 압력 : 70 Kg/Cm<sup>2</sup>
  2. 허용회전속도 : 280 MIN
  3. 사용온도 : -10~70 °C
  4. 사용유체 : ISO-VG32 or AIR

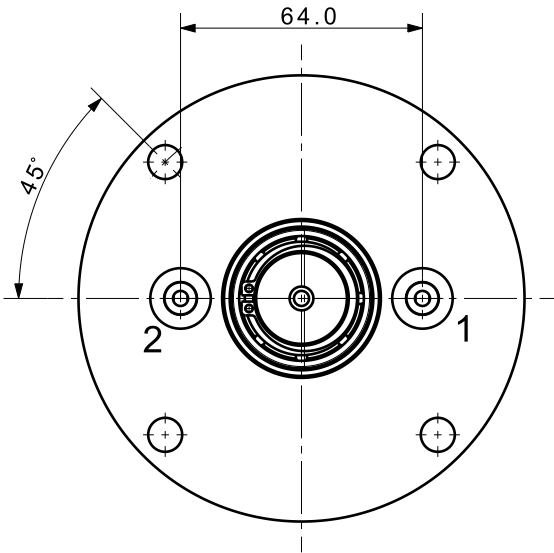

4  
"B"



View "B" (1:2)

DET.NO	NAME	Q'TY	MAT'L	FINAL SIZES & PART No	REMARK
UNLESS OTHERWISE SPECIFIED		SIGNATURES		MO-DA-YR	
DIMENSIONS ARE IN MM		DRAWN	OYS	00-00-00	
ALL SURFACES 6.3S		CHECKED			
TOLERANCES		APPROVED			
ANGLE					
X. ±					
.X ± 0.15					
.XX ±					
FINISH		WORK ORDER NO		REF DWG NO.	DWG NO
BLOCK OXIDE				---	RTC-020_-
HEAT TREAT				SCALE	TOOL <input type="checkbox"/> PART <input type="checkbox"/> SHEET OF
HRC18~22					A3